

International Student Administrator International Student Office

Closing date: 26th January 2025

Job Reference: AB44548



International Student Administrator

Salary:

£30,505-£34,866 pro rata

Contract:

Permanent

Location:

Central Cambridge

Department:

International Student Office,
Education Services

Working pattern:

Part Time 0.4 FTE

Purpose of the role

The International Student Office provides specialist support to the University's international students, is responsible for ensuring institutional compliance with Home Office student immigration requirements, advises the collegiate University on international student matters and supports student mobility activity. This part-time post (FTE 0.4) will join a small team of administrators whose role is to support the range of activities that fall within the remit of the International Student Office. The role holder will be allocated a number of duties outlined within the key responsibilities and will also be expected to contribute to the effective running of the office.

The International Student Office is part of the wider Student Administration within Education Services, responsible for administrative aspects of the student journey from registration to student progression, examination to graduation. Student Administration incorporates the Student Registry, Exams and Mitigation, the International Student Office and the Office of Student Conduct, Complaints and Appeals. The office works in partnership with the Colleges, Faculties and Departments, Admissions and other areas of student support.

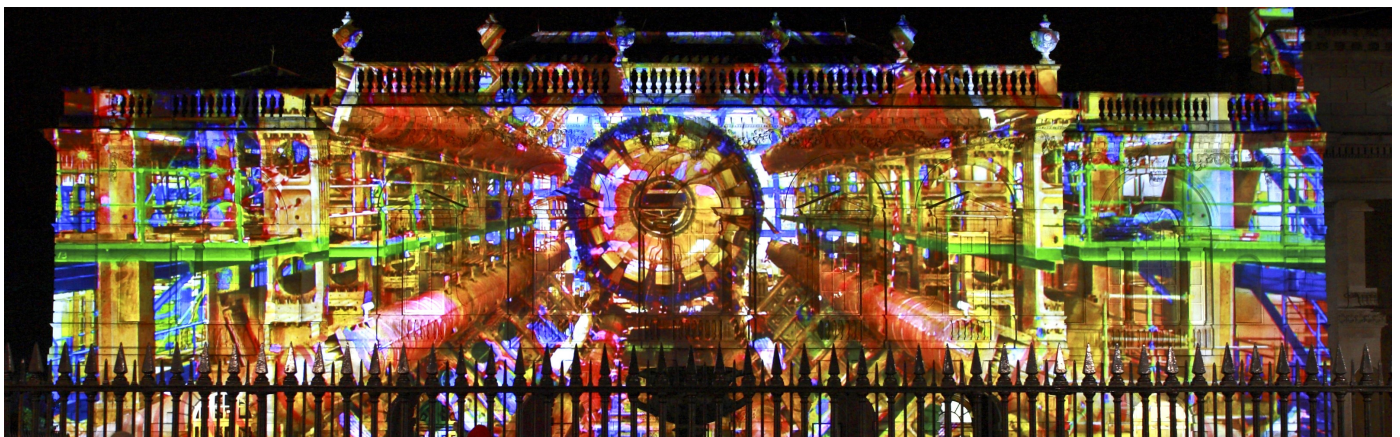

International Student Administrator

Key responsibilities

Visa advice

- Provide visa advice to prospective and current students, and their dependant family members, by email, in appointments and via workshops and webinars. This includes advising on the student visa route and the administration of the Graduate visa.

Immigration Compliance

- Administer student immigration compliance activities including CAS production, assisting with the ATAS clearance process, verifying immigration documents and tracking expiry dates, checking reports on changes of circumstances and academic engagement, ensuring contact details are up to date, advising Colleges and Departments and assisting with the preparation for a Home Office audit.

Mobility programmes

- Administer the funding process for the Turing Scheme and related mobility programmes. This includes: maintaining accurate financial data and ensuring the timely and accurate payment of funds within the budget allocation; preparing data for reports; administering the necessary paperwork; supporting relevant Faculties and Departments in coordinating participation; administering inter-institutional agreements; and assisting with internal or external audits.

Visiting students

- Provide guidance to Faculties / Departments on visiting student activity including the issuance of documentation and administration of immigration compliance responsibilities.

Funding awards

- Assist with administration of the Kurt Hahn Trust and Smuts Memorial Fund.

Contributing to international student matters

- Contribute to pre and post arrival support for international students, including orientation and updating relevant sections of the website. In addition, identify gaps in information provision and opportunities to develop the service offered to international students.

Other

- Contribute to continuous improvement of office procedures and systems to maintain efficiencies, and undertake other duties consistent with the grade supporting administration of activity within the office as required.

Person specification

Criteria	Essential	Desirable
Experience		
Experience of providing accurate, responsive and timely administrative services.	✓	
Customer-oriented experience.		✓
Experience of working in a HE setting.		✓
Qualification		
Educated to degree standard or with the skills and attributes equivalent to those expected of a graduate.	✓	
Specialist knowledge and skills		
An awareness of the needs of international students	✓	
Excellent IT skills (especially MS Excel and database systems)	✓	
Ability to understand and apply policy and ensure procedures are compliant with relevant requirements.	✓	
Competent financial administration skills.	✓	
Interpersonal & communication skills		
Effective interpersonal skills including the ability to present information clearly and succinctly.	✓	
Excellent organisational skills and the ability to prioritise and manage workload to meet deadlines.	✓	

Behavioural Attributes

This section summarises the behavioural attributes (or competencies) that we expect the role holder to be able to demonstrate, at what level and whether this is an essential or desirable requirement.

Full definitions are at: <https://www.hr.admin.cam.ac.uk/policies-procedures/behavioural-attributes>

Please review these and provide specific examples in your application of how you have demonstrated these attributes in your work, education or other experience. It will assist your application if you explain the situation, what you did and what the outcomes were.

Attribute	Level
Valuing Diversity	A
Achieving Results	C
Communication	C
Innovation and Change	C
Negotiating and Influencing	D
People Development	C
Relationship Building	C
Strategic Focus	D

Education Services



Based at the purpose built Student Services Centre, Education Services sits within the Academic Division of the University's Unified Administrative Service (UAS). Education Services comprises the following teams:

- Admissions & Participation (Including Cambridge Admissions Office and Postgraduate Admissions Office).
- Student Support, Access and Wellbeing (Including Accessibility & Disability Resource Centre, Student Counselling Service and Mental Health Advice Service)
- Cambridge Centre for Teaching and Learning
- Education Quality and Policy Office
- Student Administration (Including Student Registry, Exams and Mitigation, International Student Office, Office for Student Conduct, Complaints & Appeals).

These Departments are supported by the SSC Support Team which delivers a shared service in the following areas:

- Financial Administration
- Human Resources support, including recruitment administration
- Reception and Facilities Management

About the UAS

The University's UAS works in partnership with Schools, Faculties and Departments, providing core professional and administrative services in support of Cambridge's academic and charitable mission. They also offer a range of expertise and skills that help support the development and implementation of policy across a number of functional areas.

The UAS comprises the Academic Division, Estate Management Division, Finance Division, the Health Safety and Regulated Services Division, and the Registry's Office.

The UAS is led by the Registry. Other important central offices include Development and Alumni Relations, the Office of External Affairs and Communications, University Information Services, and the Legal Services Office.

Terms of appointment

Tenure and probation

Appointment will be made on a permanent basis, subject to satisfactory completion of a 6 month probationary period.

Hours of Work and Working Pattern

The hours of work for the position are 14.6 hours per week (0.4 FTE), with the working pattern to be agreed with the successful candidate.

Pension

You will automatically be enrolled to become a member of CPS (Contributory Pension Scheme) – a defined benefit and defined contribution pension scheme. For further information please visit: www.pensions.admin.cam.ac.uk

Annual leave

Full time employees are entitled to annual paid leave of 7.2 weeks (36 days), inclusive of public holidays. For part-time employees, annual leave will be pro rata'd based on days worked.

General information Pre-employment checks

Right to work in the UK

We have a legal responsibility to ensure that you have the right to work in the UK before you can start working for us. If you do not have the right to work in the UK already, any offer of employment we make to you will be conditional upon you gaining it.

Health declaration

Once an offer of employment has been made the successful candidate will be required to complete a work health declaration form.

Qualifications

The person specification for this position lists qualifications that are essential and/or desirable. Please note that if you are offered the post you will be asked to provide your relevant original certificates of these qualifications.

References

Offers of appointment will be subject to the receipt of satisfactory references.

Information if you have a disability

The University welcomes applications from individuals with disabilities. We are committed to ensuring fair treatment throughout the recruitment process. We will make adjustments to enable applicants to compete to the best of their ability wherever it is reasonable to do so and, if successful, to assist them during their employment. Information for disabled applicants is available at www.admin.cam.ac.uk/offices/hr/staff/disabled/

We encourage you to declare any disability that you may

have, and any reasonable adjustments that you may require, in the section provided for this purpose in the application form. This will enable us to accommodate your needs throughout the process as required. However, applicants and employees may declare a disability at any time.

If you prefer to discuss any special arrangements connected with a disability, please contact the SSC recruitment team who are responsible for the department you are applying to via email at sscjobs@admin.cam.ac.uk

The University

The University of Cambridge is one of the world's oldest and most successful universities. We are a renowned centre for research, education, and scholarship that makes a significant contribution to society. The University is consistently ranked amongst the top universities in the world. Our affiliates have won more Nobel Prizes than any other University.

Our sustained pursuit of academic excellence is built on a long history of first-class teaching and research within a distinctive collegiate system. For eight centuries our ideas and innovations have shaped the world. Our principal goal is to remain one of the world's leading universities in an increasingly competitive global higher education sector. Today the University of Cambridge is at the centre of a cluster of over 4,300 businesses employing 58,000 people.

Our capital investment projects include the West Cambridge site, the North West Cambridge development and the growth of the Biomedical Campus in the south of the city. The North West Cambridge development includes the opening of a primary school – the first in the UK to be managed by a University. So we are deeply embedded in, and committed to serving, our local community. These are all conspicuous signs of a University that is not only adapting to new needs, but also anticipating the future.

Our mission is to contribute to society through the pursuit of education, learning, and research at the highest international levels of excellence. Our core values are:

- freedom of thought and expression; and
- freedom from discrimination.

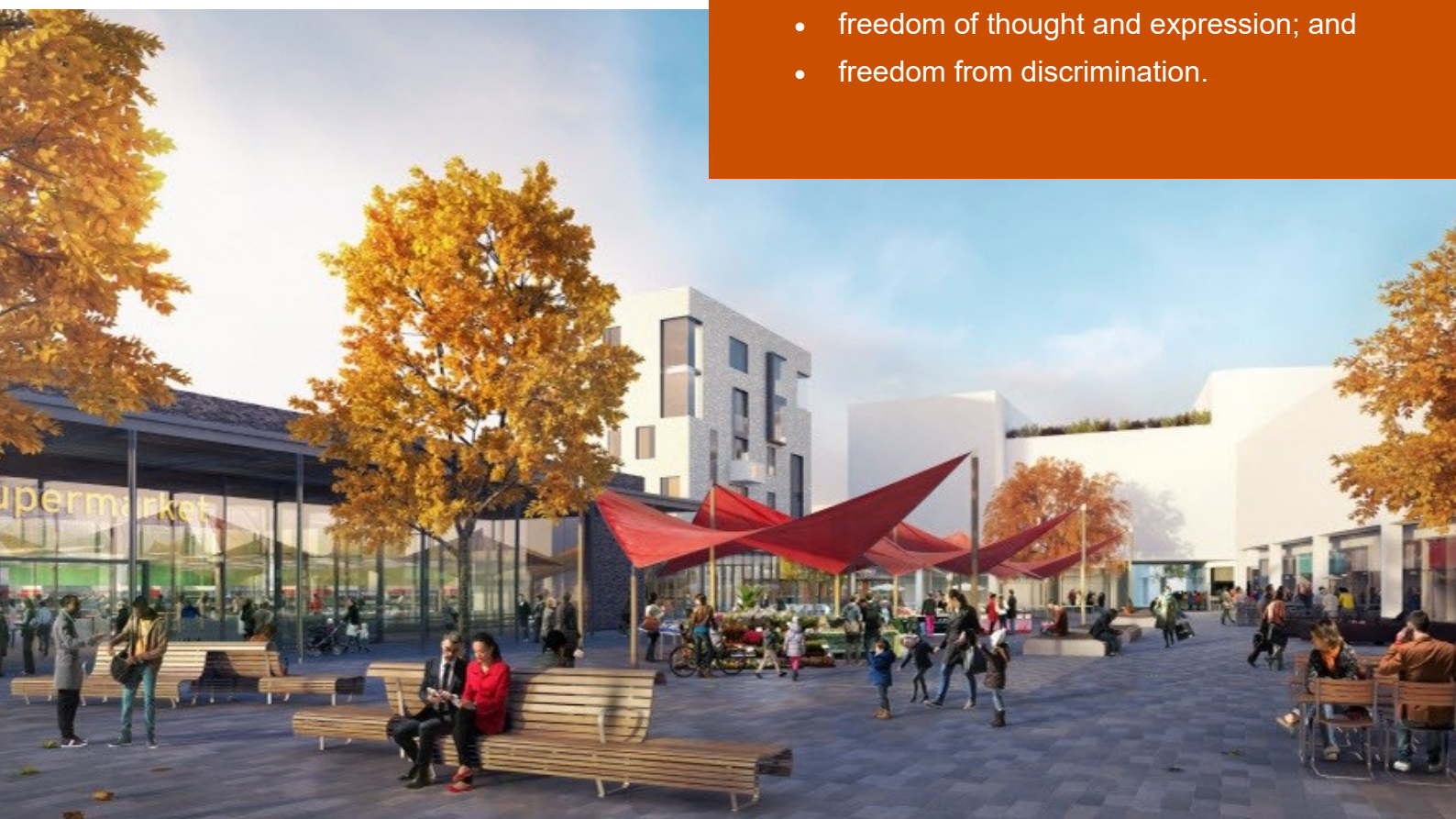

About us

The University is one of the world's leading academic centres. It comprises 150 faculties and departments, together with a central administration and other institutions. Our institutions, museums and collections are a world-class resource for researchers, students and members of the public representing one of the country's highest concentrations of internationally important collections.

The University has an annual income of £2 billion. Research income, won competitively from the UK Research Councils, the European Union (EU), major charities and industry, exceeds £500 million per annum and continues to grow.

The Colleges and the University remain committed to admitting the best students regardless of their background and to investing considerable resources both in widening access and financial support. The 31 Colleges are self-governing, separate legal entities which appoint their own staff. Many academic staff are invited to join a College as a Teaching Fellow, which provides a further social and intellectual dimension. The Colleges admit students, provide student accommodation and deliver small group teaching.

The University awards degrees and its faculties and departments provide lectures and seminars for students and determine the syllabi for teaching and conducting research.

Our instinct for seeking out excellence and setting up enduring and mutually beneficial collaborations has led us to establish strategic partnerships across the globe. Whether it is the successful Cambridge-Africa Programme involving universities in Ghana, Uganda and elsewhere on the African continent; or the close association with the government of India to pursue new research in crop science; or the creation, with Germany's Max Planck Institutes, of a Cambridge-based centre for the study of ethics, human economy and social change – international partnerships are now an inextricable part of the University's make-up.

“Cambridge graduates and researchers have made – and continue to make – a colossal contribution to human knowledge and the understanding of the world around us. Their work touches on the lives and livelihoods of everyone from patients diagnosed with life-threatening diseases, to residents of areas critically affected by climate change, to children growing up in conflict zones. It has a lasting impact on our society, our economy and our culture: the world is truly a better place thanks to their efforts.”

Stephen Toope, Vice Chancellor 2019



Working at the University

Working at Cambridge you will join a diverse, talented and innovative community, with more than 18,000 students and over 16,000 staff from all walks of life and corners of the world.

The University continually explores strategies to attract and retain the best people. It is committed to supporting its staff to achieve their best. We are a fair, diverse and inclusive society and we believe our staff are our greatest asset. There is strong commitment to developing institutional leadership and supporting and encouraging staff development at all levels.

We offer a variety of roles including academic, research, professional, managerial and support roles. We also offer extensive benefits and excellent learning opportunities within a stimulating working environment.

The University's estate is undergoing the most significant transformation in its history. Cambridge has been able to create a new science and technology campus to the west of the city centre, and is now expanding further to the north west of Cambridge including investing in affordable homes for University key workers and community facilities. Even with our continued development, the University remains within walking or cycling distance across the campus. The University is a major partner on the Cambridge Biomedical Campus and we continue to redevelop our historic city centre sites demonstrating our determination to ensure that we can offer the best facilities and opportunities for our staff and students.

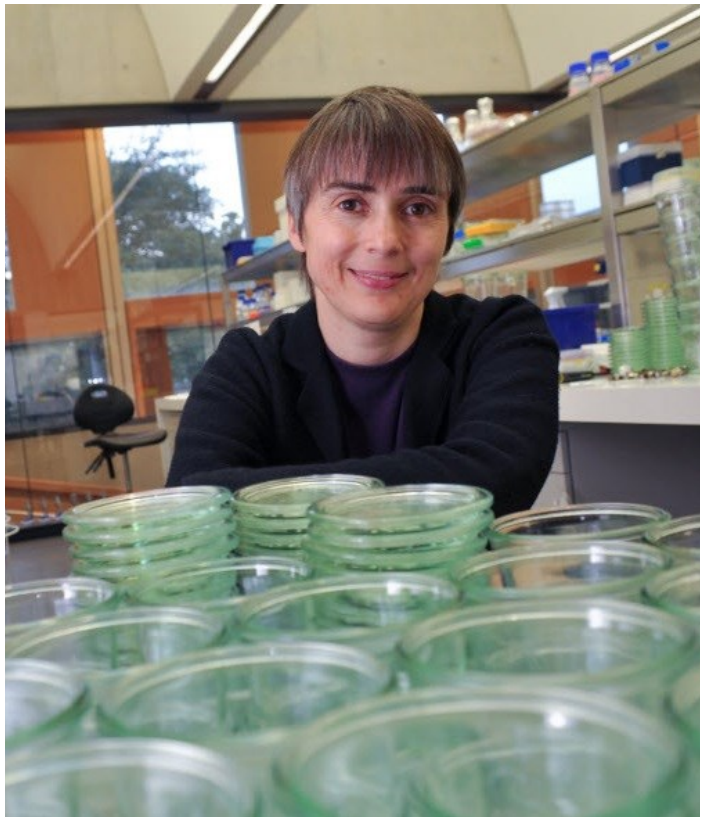

Equality & diversity

The University has built its excellence on the diversity of its staff and student community. We aim to be a leader in fostering equality and inclusion, and in promoting respect and a sense of belonging for all. We encourage applications from all sections of society. All appointments are made on the basis of merit. We have an Equal Opportunities Policy, along with a range of diversity networks for women, black and minority ethnic and lesbian, gay, bisexual and transgender staff. More details are available here: <http://www.equality.admin.cam.ac.uk/>

The University has a bronze Race Equality Charter award, with framework for improving the representation, progression and success of minority ethnic staff and students within higher education. Furthermore, the University's Athena SWAN award recognises and celebrates good practice in recruiting, retaining and promoting women.

Living in Cambridge

Cambridge is rich in cultural diversity. From beautiful University and College buildings, museums and art galleries, quaint gardens and punts on the River Cam, to a vibrant restaurant and café scene, our employees are surrounded by the wonderful features of this unique city.

You can find a wide-range of high street shops and 3 shopping centres, with independent alternatives at the historic market and nestled within the passageways in the city centre. You will find a cinema, bowling alley, a nightclub and various live performances At the Cambridge Leisure Park, with further entertainment options at the Corn Exchange, Arts Theatre and the ADC Theatre. Further information can be found on the [Visit Cambridge](#) website.

If you prefer the faster pace of life, London is a 45 minute train journey away. For those travelling from overseas, Stansted Airport is just 45 minutes away and Heathrow Airport under 2 hours away. The University is a short distance from a host of other attractions such as Ely Cathedral, Newmarket Races and various wildlife parks and stately homes. Cambridge is also within easy reach of the beautiful Broads and coastlines of Norfolk and Suffolk.

Relocation Support

The University recognises the importance of helping individuals to move and settle into a new area. We provide support and guidance to those relocating internationally or domestically to take up a post at the University of Cambridge, liaising with other University offices and selected partners to ensure comprehensive relocation support is available. This includes: accommodation, childcare, schools, banking, immigration and transport. If you would like further information, please visit <https://www.accommodation.cam.ac.uk/>. The Shared Equity Scheme and the Reimbursement of Relocation Expenses Scheme provide financial assistance to qualifying new members of staff with the costs of relocating to Cambridge.

Accommodation Service

The University Accommodation Service helps staff, students and visiting scholars who are affiliated to the University in their search for suitable accommodation in Cambridge. The dedicated accommodation team can provide access to a wide range of University-owned furnished and unfurnished properties, and has a database of private sector accommodation available for short and long-term lets. For further information and to register with this free service please visit <https://www.accommodation.cam.ac.uk/>

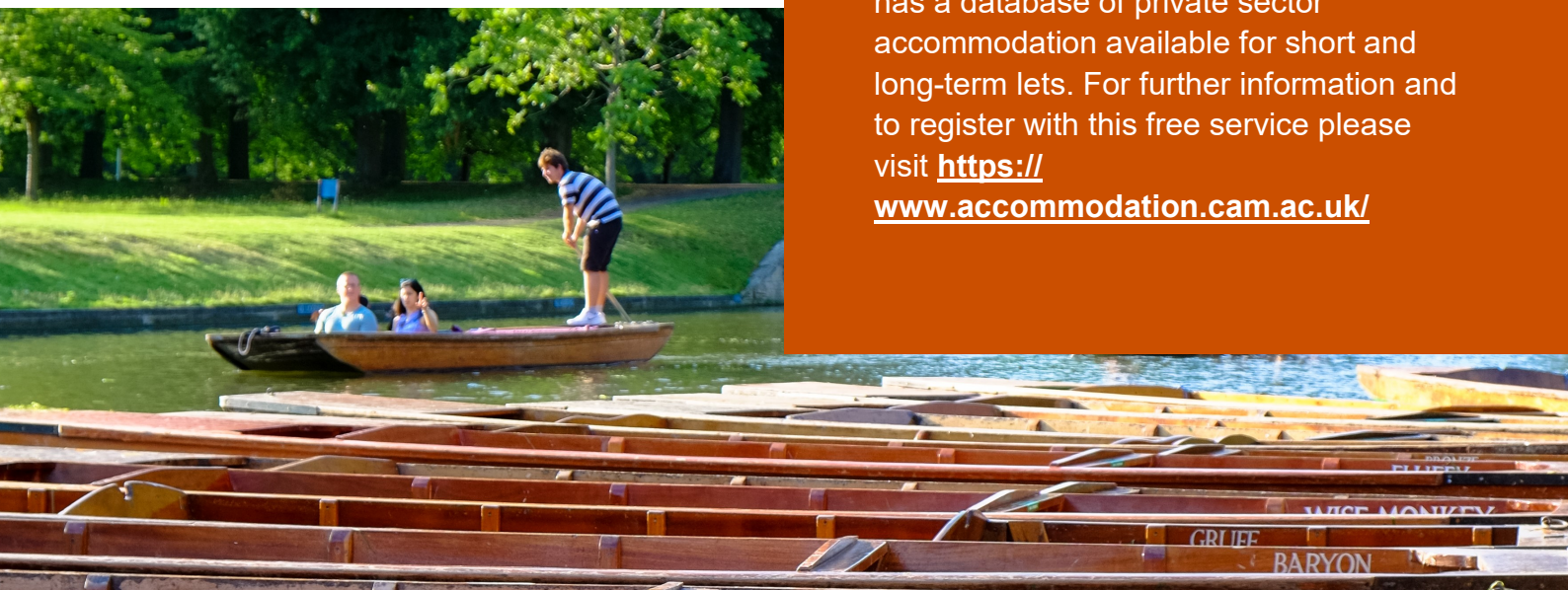

What Cambridge can offer

We offer a comprehensive reward package to attract, motivate and retain high performing staff at all levels and in all areas of work.

The University offers a wide range of competitive benefits, from family leave entitlement, to shopping and travel discount schemes. Our generous annual leave package contributes to the positive wellbeing of our University employees. Sabbatical leave enables academics to focus on research and scholarship, whilst still maintaining their full salary. The University also has a career break scheme for academic and academic-related staff, with additional flexible working policies for all other staff.

Pay and benefits

The University salary structure includes automatic service-related pay progression in many of its grades and an annual cost of living increase. In addition to this, employees are rewarded for outstanding contribution through a number of regular pay progression schemes. The University offers attractive pensions schemes for employees, with an additional benefit of a salary exchange arrangement providing tax and national insurance savings. Payroll giving is also a simple, tax-efficient way for employees to make monthly donations to charity.



CAMBens employee benefits

We offer a CAMBens scheme for University employees, providing access to online and in-store shopping discounts and cashback. With more than 2,000 participating retailers, employees can save money on a wide range of household expenses, from groceries and clothes, to holidays and insurance and much more. A range of local discounts are also available, helping employees to save money whilst also supporting local Cambridge businesses and a CAMBens Cycle to Work salary sacrifice scheme is also available, which enables employees to save money on transport costs. A 10% discount rate on the purchase of train season tickets, bulk buy tickets and an interest free travel to work loan are also available for staff of the University.



What Cambridge can offer

Family-friendly policies

The University recognises the importance of supporting its staff. We have a range of family-friendly policies to aid employees' work-life balance including a generous maternity, adoption and shared parental leave entitlement of 18 weeks full pay and emergency family care support via My Family Care.

Other family-friendly support includes: Our highly regarded workplace nurseries, a childcare salary exchange scheme and a high quality holiday Playscheme may be available to help support University employees with caring responsibilities (subject to demand and qualifying criteria). Further childcare information can be found here:
<https://www.childcare.admin.cam.ac.uk/>

The Newcomers and Visiting Scholars Group is an organisation within the University run by volunteers whose aim is to help newly arrived wives, husbands, partners and families of Visiting Scholars and members of the University to settle in Cambridge and give them an opportunity to meet local people. The Office of Postdoctoral Affairs supports the postdoctoral community within Cambridge. Further details are available here: <https://www.opda.cam.ac.uk/>

Your wellbeing

The University's Sport Centre, Counselling Services and Occupational Health are just some of the support services available to University employees to promote their physical and mental wellbeing. There are many societies in Cambridge catering for almost every taste and interest. Whether you want to take part in a sport, participate in music or drama, pursue a hobby, or join a political group, you will almost certainly find that a society exists for this purpose. The University also hosts the [Cambridge Science Festival](#) and [Cambridge Festival of Ideas](#), as well as [Open Cambridge](#) weekend, which together attract over 50,000 visitors per year. The festivals are a great opportunity to get your first taste of public engagement, through volunteering, supporting hands-on activities or proposing a talk.

Development opportunities

We support new employees to settle in through various activities. The encouragement of career development for all staff is one of the University's values and we put this into practice through various services and initiatives. Our Personal and Professional Development Department provides development opportunities and courses for all University employees. These include face-to-face sessions, online learning modules and webinars. Employees may also apply for financial support to undertake training that will lead to a qualification. We offer reduced staff fees for University of Cambridge graduate courses and the opportunity to attend lectures and seminars held by University departments and institutions. The CareerStart@Cam programme also supports employees in assistant staff roles who do not hold higher education qualifications to develop their skills, experience and qualifications.



How to apply

Applications should be submitted online via the University of Cambridge jobs page www.jobs.cam.ac.uk by clicking “Apply online” in the job advert. You will need an email address to register for our online system.

Conversations about flexible working are encouraged at the University of Cambridge. Please feel free to discuss flexibility prior to applying (using the contact information below) or at interview if your application is successful.

Informal enquiries are welcomed and should be directed to Anthony Dangerfield, Head of the International Student Office, by email at anthony.dangerfield@admin.cam.ac.uk

If you have any queries regarding the application process please contact sscjobs@admin.cam.ac.uk.

The closing date for applications is: **26th January 2025**

The interview date for the role is: **5th February 2025**